

Courses & Distances Down the river from stones to Maple

N 47 W	26	ps.
N 79 1/2 W	13	"
S 85 W	20	"
N 70 1/2 W	97	"
N 85 W	14	"
N 32 1/2 W	26	"
N 5 1/2 W	33.3	"
N 66 1/2 E	19	"
N 80 1/2 E	26	"
N 71 E	42	"
S 70 E	17	"
S 50 E	26	"
S 71 1/4 E	58	"
S 75 E	60	"
N 87 E	30	"
S 71 1/2 E	35	"
S 79 E	42	"
N 69 1/2 E	55	"
N 59 E	35	"
N 62 E	48	"
N 48 1/2 E	28.6	"

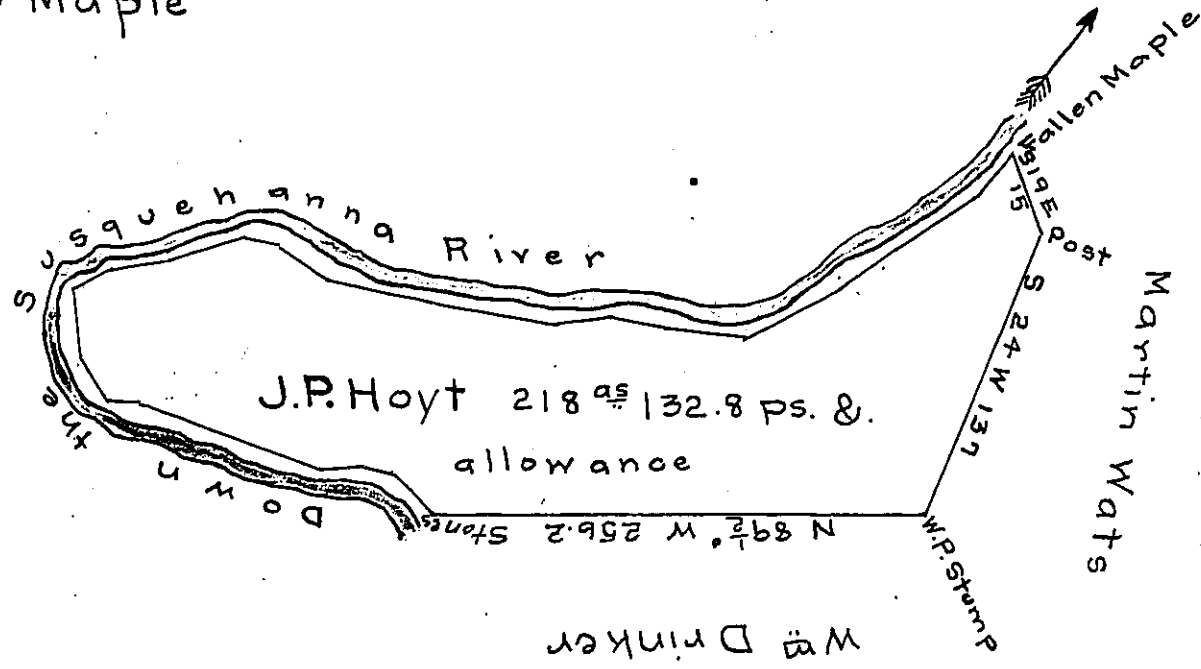

Draft of a tract of land situate in Ferguson Township Clifd. County Surveyed May 19th 1868 in pursuance of a warrant granted to John P Hoyt assignee of Joseph Wiley for two hundred acres dated twenty fifth ^{March} 1856.

To Jacob M. Campbell S.G.

S. F. M^c Closky C.S.

IN TESTIMONY that the above is a copy of the original remaining on file in the Department of Internal Affairs of Pennsylvania, made conformably to an Act of Assembly approved the 16th day of February, 1833, I have hereunto set my Hand and caused the Seal of said Department to be affixed at Harrisburg, this eleventh day of July 1905

Loach R. Brown
Secretary of Internal Affairs.